

INSTALLATION INSTRUCTIONS

VEHICLE

FORD ECONOLINE VAN

EQUIPMENT REQUIRED:

WIRING ACCESS LOCATION: SUV1, SUV2

DRILL BITS: NONE

HITCH REQUIRES 1/2" PIN AND CLIP.

WRENCHES: (TIGHTEN ALL FASTENERS WITH TORQUE WRENCH) 3/4, 7/8

NO DRILLING REQUIRED, USES ALL EXISTING HOLES.

3500 LB MAX GROSS TRAILER WT
300 LB MAX TONGUE WEIGHT
DO NOT EXCEED TOWING VEHICLE RATINGS

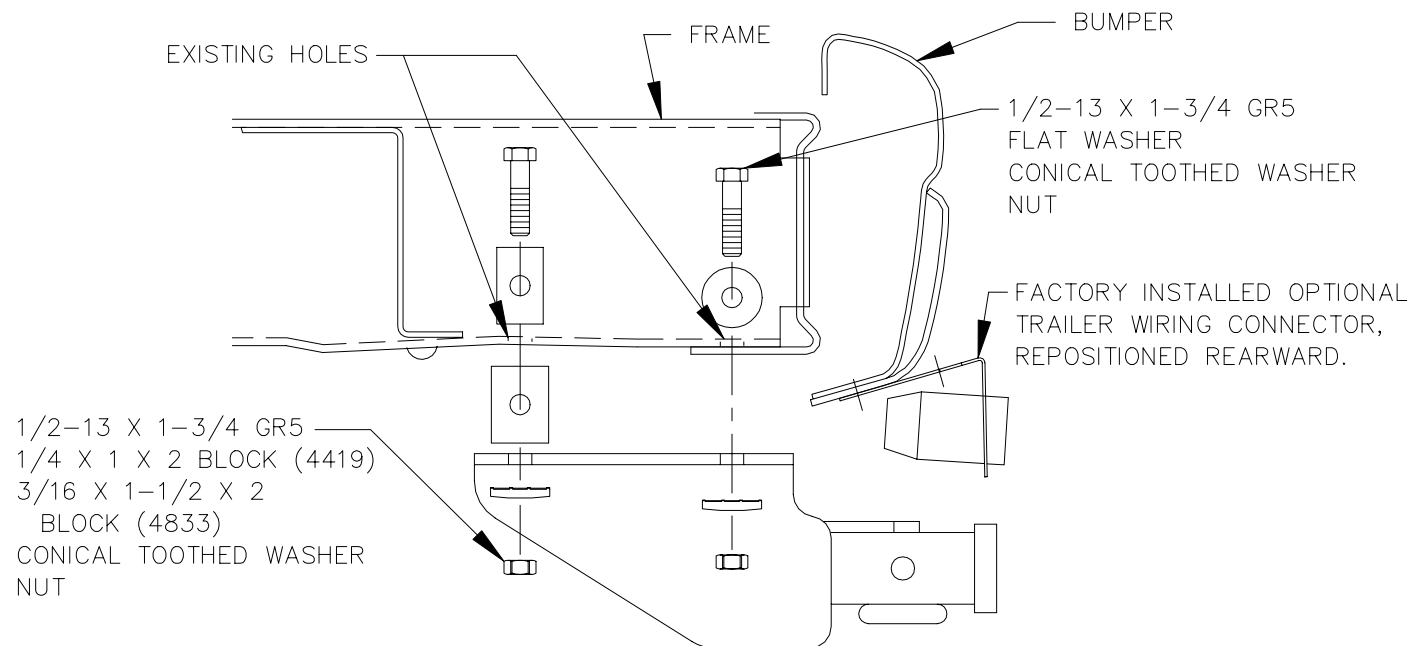

NOTE: WIRING HARNESS IS LOCATED INSIDE THE VEHICLE FRAME. REPOSITION PRIOR TO INSTALLING BOLTS.

1. DISCONNECT FACTORY INSTALLED OPTIONAL TRAILER WIRING CONNECTOR FROM BUMPER.
2. POSITION HITCH ON VEHICLE AS SHOWN, LINING UP WITH EXISTING HOLES IN FRAME.
3. INSTALL HEX BOLTS, BLOCKS, FLAT WASHERS, CONICAL TOOTHED WASHERS, AND NUTS AS SHOWN ABOVE.

TIGHTEN 1/2-13 GR5 FASTENERS TO 75 LB.-FT.

4. REINSTALL FACTORY TRAILER WIRING CONNECTOR TO CLEAR HITCH.

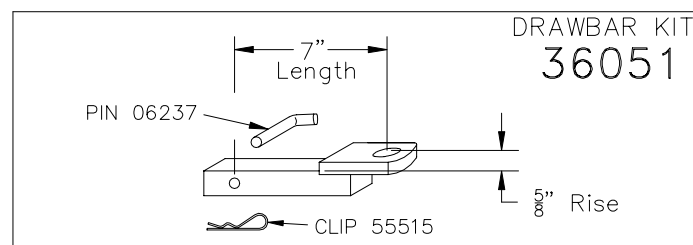

USE ONLY THE DRAWBAR SHOWN FOR CORRECT BUMPER CLEARANCE AND HEIGHT.
DRAWBAR MUST BE USED IN THE RISE POSITION ONLY.

THIS PRODUCT COMPLIES WITH SAFETY SPECIFICATIONS AND REQUIREMENTS FOR CONNECTING DEVICES AND TOWING SYSTEMS OF THE STATE OF NEW YORK, V.E.S.C. REGULATION V-5 AND SAE J684.

APPROX WEIGHT (LB.)

23

FASTENER KIT

01130-802

NOTE: Check hitch frequently, making sure all fasteners and ball are properly tightened. If hitch is removed, plug all holes in trunk pan or other body panels to prevent entry of water and exhaust fumes. A hitch or ball which has been damaged should be removed and replaced. Observe safety precautions when working beneath a vehicle and wear eye protection. Follow car maker's specs for maximum trailer weight and tongue weight. Do not cut access or attachment holes with a torch.

TOWING PRODUCTS
Plymouth, Michigan