

# Installation Instructions

## 20K HITCH

Part Numbers:  
**38023N**

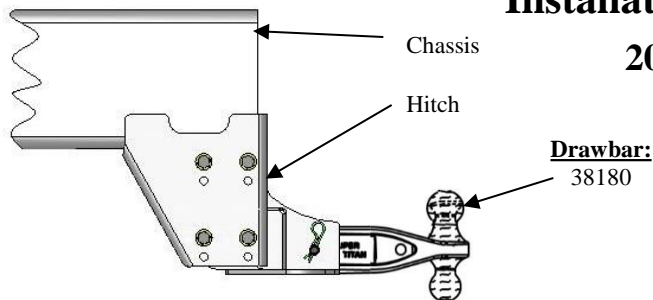

**Do Not Exceed Lower of Towing Vehicle  
Manufacturer's Rating or**

**20,000 LB (9072 Kg) Max Gross Trailer Weight  
3,000 LB (1360.8 Kg.) Max Tongue Weight**

**Hitch Shown In Proper Position**

**Equipment Required:**

- Fastener Kit:** N/A
- Wrenches:** 15/16"
- Drill Bits:** None

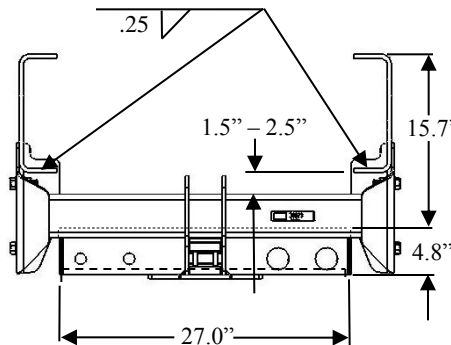

FRONT OF CHASSIS LOOKING REARWARD

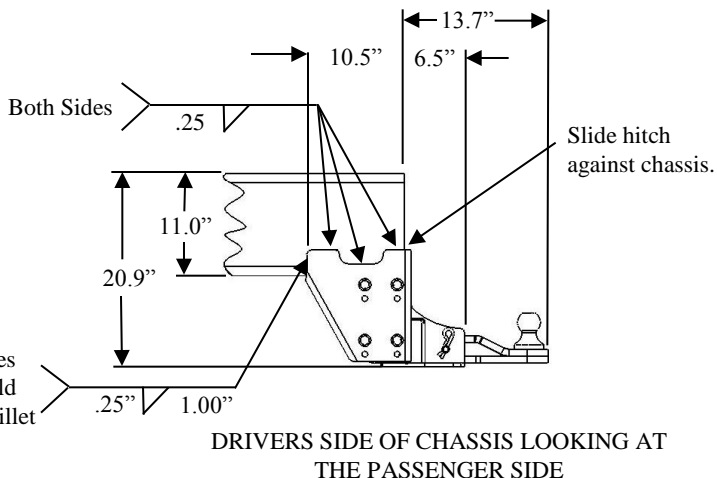
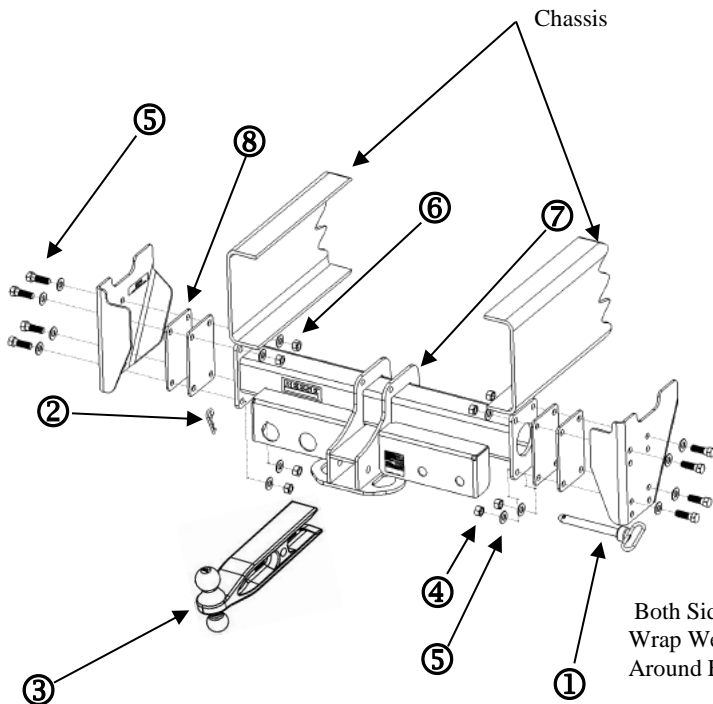

DRIVERS SIDE OF CHASSIS LOOKING AT  
THE PASSENGER SIDE

①	Qty. (1)	3/4" Hitch Pin with Lanyard	⑤	Qty. (16)	Harden Washer 5/8"
②	Qty. (1)	Clip	⑥	Qty. (8)	Hex Bolt (5/8" – 11 x 2" Grade 8)
③	Qty. (1)	Drawbar	⑦	Qty. (1)	Hitch
④	Qty. (8)	Hex Nut (5/8" – 11 Grade 8)	⑧	Qty. (4)	Spacer

1. Measure chassis width. If chassis measurement is greater than 34.50 inches then loosen hitch fasteners (Items 4,5 & 6). If Chassis is less than 34.5 inches remove spacers (Item 8) as required.
2. Raise hitch into position. If fasteners were loosen, torque hitch fasteners (Items 4,5 & 6) while hitch is in position.
3. Weld hitch to chassis as shown above.
4. Check Torque on hitch fasteners (Items 4,5 & 6) to:

**Tighten 5/8" – 11 Grade 8 fasteners to 190 lb.-ft. (257.6 N\*M)**

Note: check hitch frequently, making sure all fasteners and ball are properly tightened. A hitch or ball which has been damaged should be removed and replaced. Observe safety precautions when working beneath a vehicle and wear eye protection. Do not cut access or attachment holes with a torch.

This product complies with safety specifications and requirements for connecting devices and towing systems of the state of New York, V.E.S.C. Regulation V-5 and SAE J684.