



BLUE OX®

BX1115

1999-2003 Jeep Grand Cherokee Installation Instructions

Serial Number

Attachment Tab Height: 17"

Attachment Tab Width: 20"

Please read BOTH these Installation Instructions and the General Instructions prior to installing or operating this equipment.

1. Blue Ox® towing products and accessories are intended to be installed by Blue Ox® Dealers who are familiar with our products and have the equipment and knowledge necessary to do "fit work". If needed, Blue Ox® Dealers can be found at www.blueox.com or by contacting our Customer Care Department at (402) 385-3051.
2. Many Blue Ox® baseplates are designed to use existing holes and hardware to mount the baseplate to the towed vehicle. Even though bolts are there, do not assume they are adequate for baseplate mounting. Always use the hardware supplied in the hardware kit and existing hardware as specified in the installation instructions.

Bolt Torque Specifications
Torque in Foot-Pounds for Metric Bolts

Bolt Size	Grade 8.8	Grade 10.9
6MM	6	8
8MM	16	22
10MM	31	40
12MM	54	70
14MM	89	117

Bolt Torque Specifications
Torque in Foot-Pounds for Inch Bolts

Bolt Size	Grade 5	Grade 8
1/4"	10	14
5/16"	19	29
3/8"	33	47
7/16"	54	78
1/2"	78	119
5/8"	154	230

Reference your vehicle owner's manual for manufacturer's towing specifications.

! WARNING

Failure to read and follow these instructions could result in separation of the towed vehicle from the tow bar, causing property damage, loss of towed vehicle, personal injury or death.



BLUE OX

BX1115

1999-2003 Jeep Grand Cherokee Installation Instructions

Parts List

Ref. No.	Qty.	Part #	Description
1	1	61-5295	Weldment, Baseplate, BX1115
2	4	61-5208	Weldment, 3/8" Nutplate, with Wire
3	2	102-5597	Weldment, Side Plate Support
4	2	102-5598	Rear Spacer
5	4	201-0444	3/8-16 x 2" Hex Bolt, Grd. 5
6	4	203-0010	3/8" Lock Washer
7	4	203-0003	3/8" Flat Washer
8	2	201-0979	#12-14 x 1" Self Drilling Screw, ZP
9	2	201-0192	#10-32 x 1/2" Slotted Screw
10	2	203-0054	#10 Lock Washer
11	2	202-0047	#10 Hex Nut
12	2	101-5822	4 Way Connector
13	2	62-3468	Removable Tabs, SF/SB
	2	226-0046	Baseplate Safety Cable, 36" CL III (Not Shown)
	2	229-0359	Quicklink 3/8, ZP (Not Shown)
	6	229-0536	6.3MM Plastic Rivet (Not Shown)
	2	290-0437	Receiver, Cap Plug (Blk) (Not Shown)

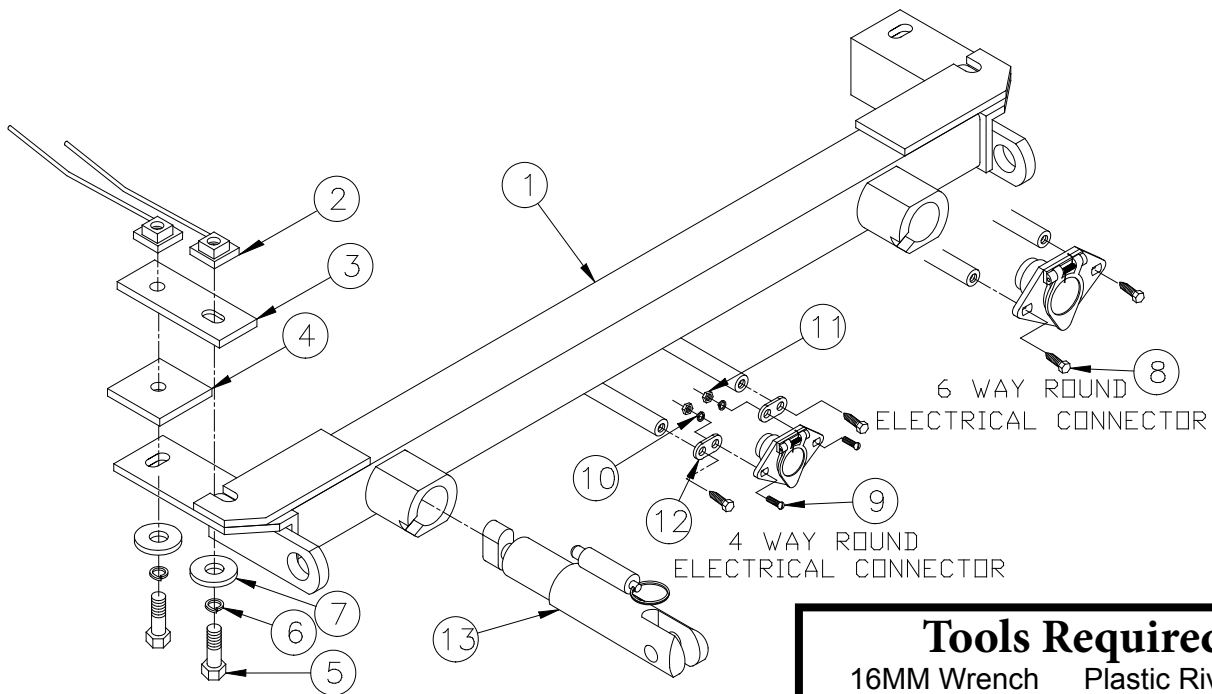

Tools Required

- | | |
|-------------|-------------------|
| 16MM Wrench | Plastic Rivet Gun |
| 17MM Wrench | Drill |
| 18MM Wrench | Flat Screwdriver |
| 3/4" Wrench | Loctite® RED |

Important:

Use only genuine factory replacement parts on your baseplate. Do **NOT** substitute homemade or non-typical parts. If a bolt is lost or in need of replacement, for your safety and the preservation of your baseplate, be sure to use a replacement bolt of the same grade (In most cases it will be Grade 5, please reference the parts list above). Replacement parts may be ordered through your nearest Blue Ox® Dealer or Distributor.



BLUE OX®

BX1115

1999-2003 Jeep Grand Cherokee Installation Instructions

Removable Tabs:

Motorhome mount tow bars are recommended for the use with this baseplate. Due to the design of the removable tabs, the RangeFinder II, Adventurer, and Ambassador tow bars can not be used. The Acclaim tow bar may be used, but will not fold and store on the front of the vehicle. Adapters, except the BX8833 and the BX88151, can not be used with this baseplate.

Installation Notes:

The front fascia is removed and reinstalled during the baseplate installation. Factory tow hooks will NOT be reinstalled. Drilling is required.

The dimensional variations between otherwise identical vehicles can be considerable. While the baseplate was designed for easy installation, it may be necessary to tailor the baseplate slightly to compensate for auto manufacturer's tolerances. These minor adjustments may include filing a hole slightly, bending electrical rods, and/ or bending end plates.

The BX8869 Bulb and Socket Wiring Kit is recommended for this vehicle.

Installation Instructions:

1. Remove the three plastic rivets fastening the fender well molding to the bumper molding. Pull back the plastic molding to the bumper molding and remove the hex head bolts connecting the quarter panels and the bumper molding.
2. Remove the pushpins from the bottom of the bumper molding. Also remove the Phillips screws on the face and top of the chrome grille (four on the top and three on the face of the grille). Pull forward to remove the bumper. Set the bumper and the bolts aside to be reinstalled later.
3. The outside holes for the baseplate will line up to existing holes in the frame. Place 1/4" support inside the frame. Start a 3/8" bolt and nut washers for the forward holes. Be sure to apply LOCTITE Red.
4. Now place the 2" square spacer between the frame and the baseplate for the rear holes. Use the 3/8" hardware same as step 4. Once all bolts have been started torque each one according to the Torque Specification Chart in the General Instructions Sheet.
5. Replace the bumper molding. Enclosed in the bolt bag are plastic rivets to replace the ones that were removed in the first steps.
6. Install the tow bar and safety cables according to the instructions included in their packages. Do not substitute other devices if the tow bar pin and clip are lost.

BE SURE TO USE LOCTITE® RED ON ALL BOLTS BEFORE TIGHTENING. TIGHTEN ALL BOLTS ACCORDING TO THE TORQUE CHART ON THE FRONT PAGE OF THESE INSTRUCTIONS OR ON PAGE 3 OF THE BASEPLATE TOWING GENERAL INSTRUCTIONS.



BLUE OX®

BX1115 1999-2003 Jeep Grand Cherokee Installation Instructions



**Location of the BX8869
Bulb & Socket Wiring Kit.**

DEALER or INSTALLER:

**Be certain the user receives the
instruction sheets for their products.**

CUSTOMER SERVICE COMMITMENT

Blue Ox® is committed to providing you with exceptional customer care throughout your lifetime with our products. Our team is here to assist you with any questions you may have regarding the performance of your product. Simply call (402) 385-3051 and you can speak with our customer care team.

Additionally, please visit our website to see which rallies our Destination America team will be attending. For a nominal fee, our service technician will service your towing system to ensure it's in proper working condition. Also, as a commitment to our customers, should you visit our factory, you can stay at our full service Blue Ox® campground at no charge along with enjoying a factory tour.

Again, thank you for being our customer and for the confidence you have shown in the performance of our products. It is because of customers like you we enjoy the success we have today.



**Shown with
Removable tabs Installed**



Shown without removable tabs



BLUE OX®

© 2008 Blue Ox
One Mill Road, Industrial Park
Pender, Nebraska 68047
Phone: (402) 385-3051
Fax: (402) 385-3360
www.blueox.com