



BLUE OX®

BX3511

1999 Suzuki Grand Vitara JLX and JLX Plus
Installation Instructions

Serial Number

Please read BOTH these Installation Instructions and the General Instructions prior to installing or operating this equipment.

- Blue Ox® towing products and accessories are intended to be installed by Blue Ox® Dealers who are familiar with our products and have the equipment and knowledge necessary to do “fit work”. If needed, Blue Ox® Dealers can be found at www.blueox.com or by contacting our Customer Care Department at (402) 385-3051.
- Many Blue Ox® baseplates are designed to use existing holes and hardware to mount the baseplate to the towed vehicle. Even though bolts are there, do not assume they are adequate for baseplate mounting. Always use the hardware supplied in the hardware kit and existing hardware as specified in the installation instructions.

Reference your vehicle owner’s manual for manufacturer’s towing specifications.

Bolt Torque Specifications
Torque in Foot-Pounds for Inch Bolts

Bolt Size	Grade 5	Grade 8
1/4"	10	14
5/16"	19	29
3/8"	33	47
7/16"	54	78
1/2"	78	119
5/8"	154	230
3/4"	257	380

Bolt Torque Specifications
Torque in Foot-Pounds for Metric Bolts

Bolt Size	Grade 8.8	Grade 10.9
6MM	6	8
8MM	16	22
10MM	31	40
12MM	54	70
14MM	89	117
16MM	161	230
18MM	222	318

! WARNING

Failure to read and follow these instructions could result in separation of the towed vehicle from the tow bar, causing property damage, loss of towed vehicle, personal injury or death.

BX3511
1999 Suzuki Grand Vitara JLX and JLX Plus
Installation Instructions

Instruction Notes: This baseplate mounts using two existing holes in the engine supports and two holes will be drilled in the underside of the metal bumper. The front bumper covering and headlight assemblies will NOT need to be removed for this installation.

The dimensional variations between otherwise identical vehicles can be considerable. While the baseplate was designed for easy installation, it may be necessary to tailor the baseplate slightly to compensate for vehicle manufacturer's tolerances.

NOTICE

- When using power drills be aware of the dangers of torque and drill bit length.
 - When using a reciprocating saw be aware of objects behind the cutting surface.
 - Use a good quality paint to spray cut edges of frame to prevent rusting.
 - Be sure that **ALL** electrical connections are plugged in and accessories are functioning properly before reinstalling the fascia.
 - Do not use the towed vehicle for storing luggage, equipment, etc. This may cause you to exceed the towing capacity of the tow bar, baseplate and its accessories.
 - Be sure to use Loctite® Red on all bolts before tightening. Tighten all bolts according to the torque chart provided.
 - Dealer or installer be certain the user receives these instruction sheet.
 - If the baseplate is in an accident, it must be replaced. **DO NOT** use it again! An accident can cause unseen damage and using it again could result in more damage or serious injury. **DO NOT** use the baseplate if it is damaged or missing parts.
1. Looking at the underside of the vehicle, note that there are four existing bolts, per side, at the engine supports. Remove the front, inboard bolt on each side of the vehicle using a 17mm socket and ratchet. **NOTE:** These bolts will not be used during the installation of the baseplate.
 2. Hold the baseplate up in position with the holes in the support arms over these holes and loosely bolt in place with the 12mm x 120mm bolts provided. Snug the bolts to hold the baseplate in position. Push the baseplate up until the vertical supports contact the metal bumper and mark the underside of the bumper where holes will need to be drilled for the vertical braces to be attached.
 3. Drill the two holes in the underside of the bumper using a 1/2 inch drill bit. **NOTE:** It may make drilling easier if you have someone help you by holding the plastic bumper covering forward, out of the way.
 4. Apply loctite to the 12mm x 120mm bolts with washer and start them through the support arms into the engine support holes, do not completely tighten.
 5. Insert each wire nut plate in appropriate end of the bumper and center them over the drilled holes. Apply loctite to the 1/2 inch bolts provided with washer. Using a 3/4" socket and extension, thread them up through the vertical brackets in the baseplate and into the wire nut plates inside the bumper.
 6. Tighten all four bolts completely according to the Bolt Torque Chart.
 7. Attach the permanent baseplate safety cables to the provided convenience link on the baseplate. Secure the cables to a solid piece of the frame as described in the instructions included with the permanent baseplate safety cables. Be sure the safety cables do not rub against any hoses or moving parts. Do this on **BOTH** sides of the vehicle.

BX3511

1999 Suzuki Grand Vitara JLX and JLX Plus Installation Instructions

Tools Required

Torque Wrench
 Drill
 Loctite® RED
 1/2" Drill Bit
 17MM Socket
 3/4" Socket
 3/4" Wrench

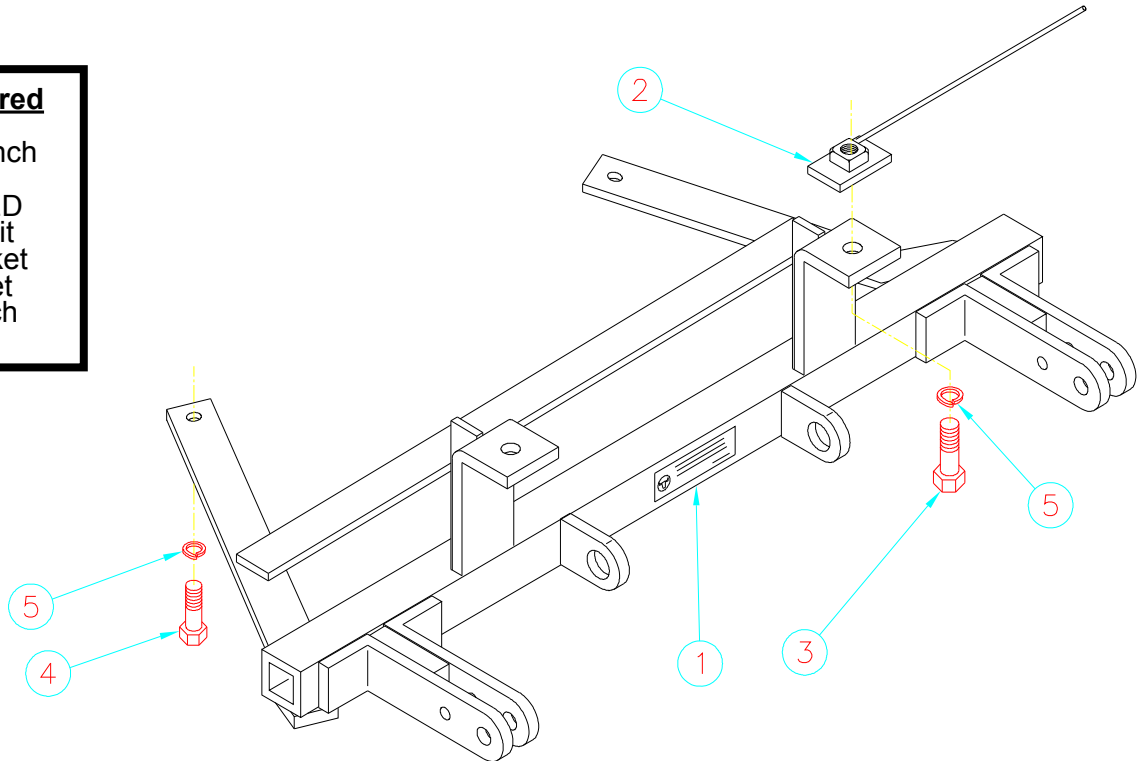

Item No.	Part No.	Description	Qty.
1.....	61-5248.....	BX3511 Baseplate.....	1
2.....	61-5249.....	Driver Side Wire Nut Plate.....	1
3.....	201-0051.....	1/2"-13 x 1-1/2" Hex Head Bolt, Grade 5.....	2
4.....	201-0610.....	12MM-1.25 x 120MM Hex Head Bolt Grade 8.8.....	2
5.....	203-0012.....	1/2" Lock Washer.....	4
6.....	61-5274(not shown).....	Passenger Side Wire Nut Plate.....	1
7.....	226-0046(not shown).....	Class III Safety Cables.....	2
8.....	229-0359(not shown).....	3/8" Quicklink, ZP.....	4

Important:

Use only genuine factory replacement parts on your baseplate. Do **NOT** substitute homemade or non-typical parts. If a bolt is lost or in need of replacement, for your safety and the preservation of your baseplate, be sure to use a replacement bolt of the same grade (In most cases it will be Grade 5, please reference the parts list above). Replacement parts may be ordered through your nearest Blue Ox® Dealer or Distributor. Failing to follow and/or altering these installation instructions in either installation or required equipment will void the manufacturer's warranty. Towing behind a non-motorized vehicle will void the warranty.

CUSTOMER SERVICE COMMITMENT

Blue Ox® is committed to providing you with exceptional customer care throughout your lifetime with our products. Our team is here to assist you with any questions you may have regarding the performance of your product. Simply call (402) 385-3051 and you can speak with our customer care team.

Additionally, please visit our website to see which rallies our Destination America team will be attending. For a nominal fee, our service technician will service your towing system to ensure it's in proper working condition. Also, as a commitment to our customers, should you visit our factory, you can stay at our full service Blue Ox® campground at no charge along with enjoying a factory tour.

Again, thank you for being our customer and for the confidence you have shown in the performance of our products. It is because of customers like you we enjoy the success we have today.

© 2012 Blue Ox
 One Mill Road, Industrial Park
 Pender, Nebraska 68047
 Phone: (402) 385-3051
 Fax: (402) 385-3360
 www.blueox.com