



BLUE OX®

Baseplate Installation Instructions

BX3524

**2011-12 Suzuki Kizashi Sport GTS
Installation Instructions**

Serial Number

Please read BOTH these Installation Instructions and the General Towing Instructions before attempting to install or operate this equipment.

- Blue Ox® towing products and accessories are intended to be installed by Blue Ox® Dealers who are familiar with our products and have the equipment and knowledge to do “fit work”. When necessary, Blue Ox® Dealers can be found at www.blueox.com or by contacting our 24/7 Customer Care Department at (402) 385-3051.
- Many Blue Ox® Baseplates are designed to use existing holes and hardware to mount the baseplate to the towed vehicle. Even though bolts are there, do not assume they are adequate for baseplate mounting. Always use hardware supplied in the hardware kit or existing hardware specified in the Baseplate Installation Instructions.

Attachment Tab Height: 14”
Attachment Tab Width: 18”

Bolt Torque Specifications

Torque in Foot-Pounds per Metric Bolts

Bolt Size	Grade 8.8	Grade 10.9
6MM	6	8
8MM	16	22
10MM	31	40
12MM	54	70
14MM	89	117

Confirm the towability and pre-towing procedures for your vehicle with the owner’s manual or contact the vehicle’s manufacturer for specific towing procedures. You can also contact REMCO for additional information at 1(800)228-2481.

Bolt Torque Specifications

Torque in Foot-Pounds per Inch Bolts

Bolt Size	Grade 5	Grade 8
1/4”	10	14
5/16”	19	29
3/8”	33	47
7/16”	54	78
1/2”	78	119
5/8”	154	230



If the front of your vehicle looks different than this, call us at (402) 385-3051.

⚠ WARNING

Failure to read and follow these instructions could result in separation of the towed vehicle from the tow bar, causing property damage, loss of towed vehicle, personal injury or death.

BX3524

2011-12 Suzuki Kizashi Sport GTS Installation Instructions

Parts List

Ref. No.	Qty.	Part #	Description
1	1	61-6920	WLDM'T, BP, BX3524
2	1	102-7056	COOLANT BRKT
3	1	201-0050	1/4-20 X 3/4 HEX BOLT, GRD. 5, ZP
4	8	201-0440	3/8-16 X 1 1/2" HEX BOLT, GRD. 5, ZP
5	1	201-0654	#10-16 X 1" SELF DRILLING SCREW, ZP
6	1	202-0102	1/4-20 HEX NYL NUT, ZP
7	8	203-0010	3/8" LOCK WASHER, ZP
8	8	61-5208	WLD, NUT PLATE, 1/4 X 1 X 1 3/8/14" WIRE
9	2	101-5822	ADAPTER, 4 WAY CONNECTOR
10	2	201-0192	#10-32-1/2" SLOT, RD. HD. SCREW
11	2	201-0553	1/4-20 X 1/2" HEX WASHED, TYPE F, ZP
12	2	202-0047	#10-32 HEX NUT
13	2	203-0054	#10-32 LOCK WASHER
14	2	62-3469	ATT TAB ASSY, REM,SF/LB, 1 HOLE
	2	290-0437	RECEIVER, CAP PLUG (BLK) (Not Shown)
	2	226-0046	BASEPLATE SAFETY CABLE, 36" CLASS III (Not Shown)
	2	229-0359	QUICK LINK, 3/8", ZP (Not Shown)

Tools Required

Loctite® RED	10MM Socket	12MM Socket	13MM Socket
9/16" Socket	Large Vise Grip	Phillips Screwdriver	Torque Wrench
Tape Measure		Drill	Loctite Red

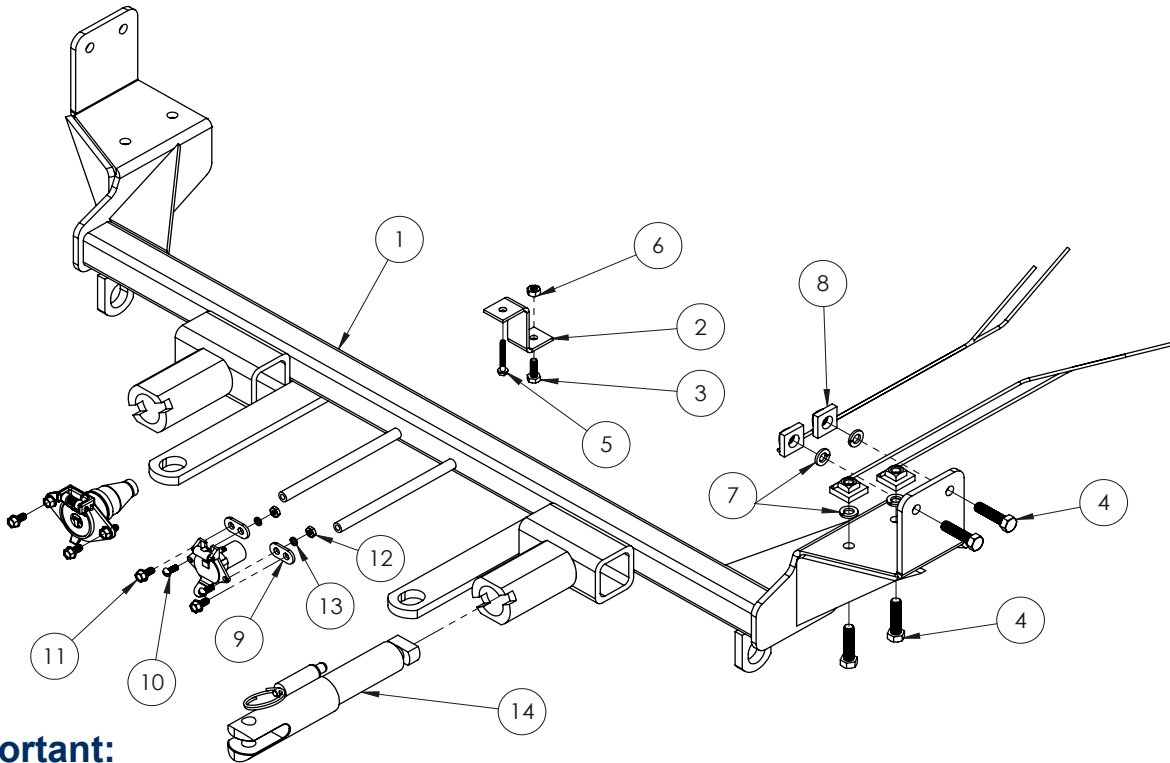

Important:

Use only genuine factory replacement parts on your baseplate. Do **NOT** substitute homemade or non-typical parts. If a bolt is lost or in need of replacement, for your safety and the preservation of your baseplate, be sure to use a replacement bolt of the same grade (In most cases it will be Grade 5, please reference the parts list above). Replacement parts may be ordered through your nearest Blue Ox® Dealer or Distributor.

BX3524

2011-12 Suzuki Kizashi Sport GTS Installation Instructions

Attachment Tabs: Due to the design of the removable tabs, the RangeFinder II, Acclaim and Ambassador tow bars can not be used. Adapters, except the BX8833 and BX88151, can not be used with this baseplate.

Installation Notes: The fascia, front bumper and bellypan will be removed for installation. Trimming of the fascia is required. Drilling will be required. The bolts that secure the bumper will be replaced during installation.

The dimensional variations between otherwise identical vehicles can be considerable. While the baseplate was designed for easy installation, it may be necessary to tailor the baseplate slightly to compensate for auto manufacturer's tolerances. These minor adjustments may include filing a hole slightly, bending electrical rods, and/or bending end plates.

The BX8848 Wiring Kit is recommended for this vehicle.

Installation Instructions:

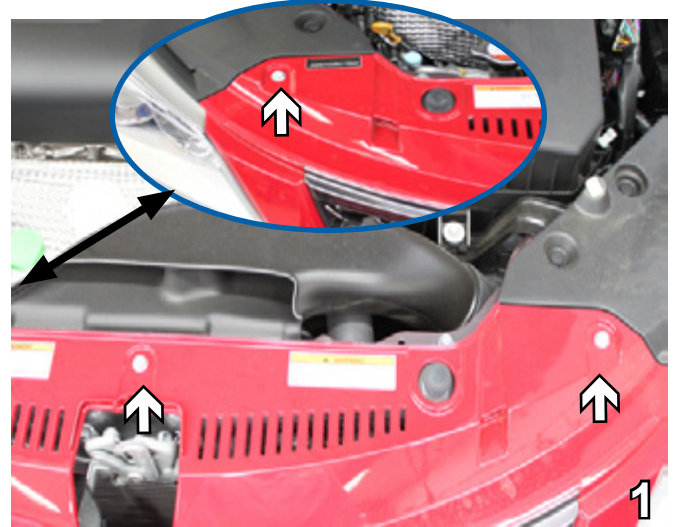

1. Using a 10MM socket, remove a bolt from the top of each side and the middle of the fascia. Set bolts aside to be reinstalled later.



2. Use a Phillips screw driver and remove the screw concealed in the front of the wheel well. Do this on both sides of the vehicle. Set aside screws to be reinstalled later.

BX3524

2011-12 Suzuki Kizashi Sport GTS Installation Instructions

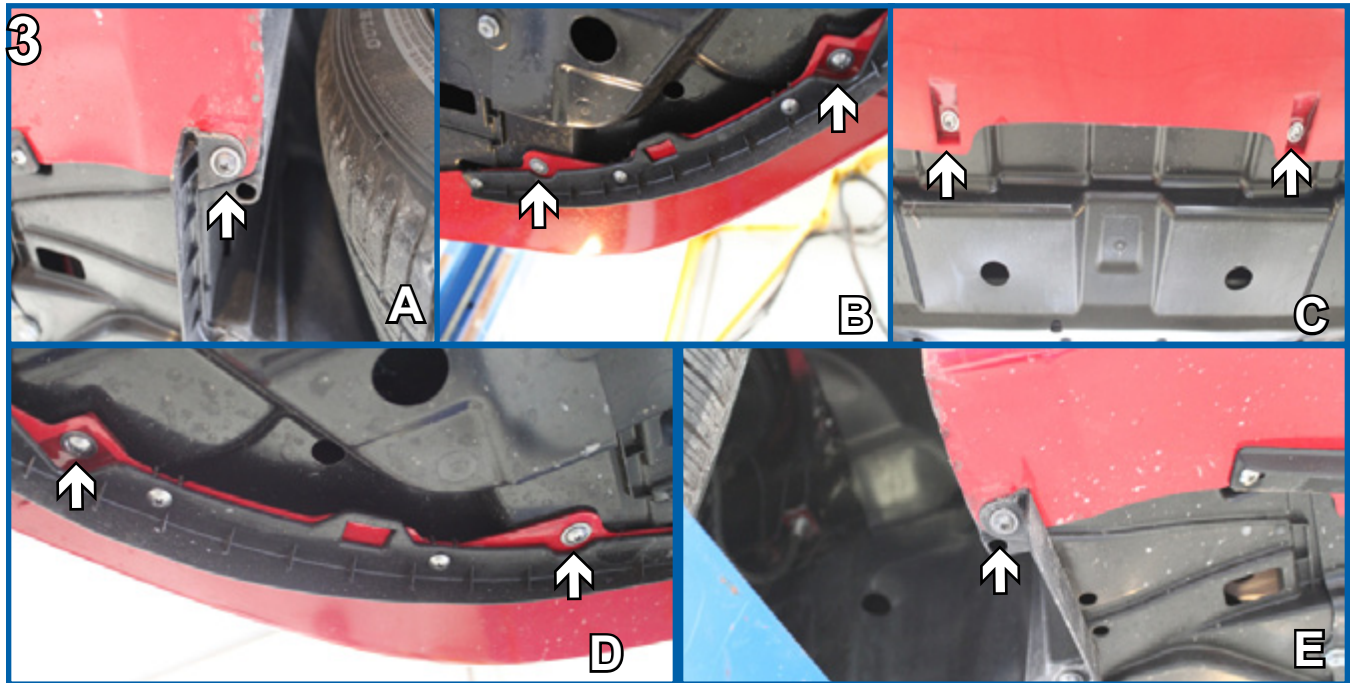

3. Starting in front of the driver's side wheel, on the underside of the fascia, use a Phillips screwdriver to remove eight total screws from the rim of the fascia. Set screws aside to be reinstalled later.

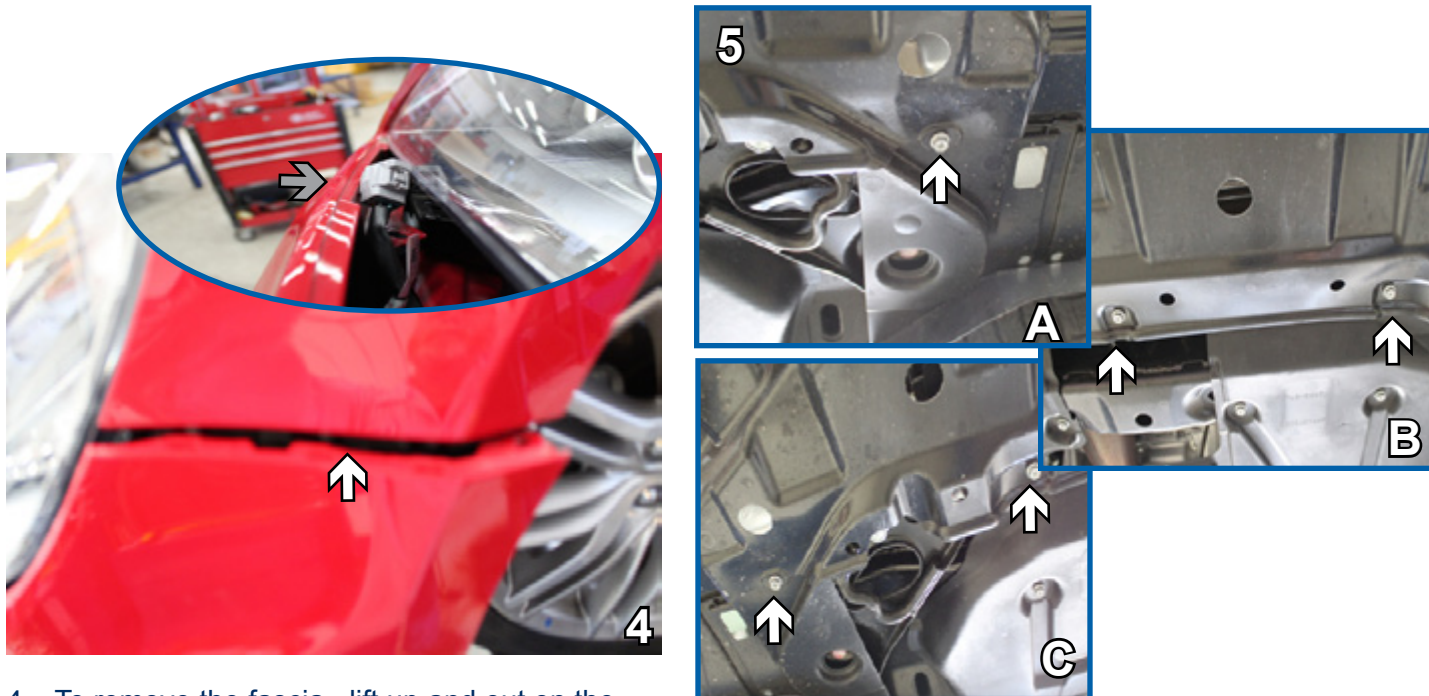

4. To remove the fascia, lift up and out on the fascia near each front tire (white arrow). To disconnect the fascia, unplug the white electrical connection located below each headlight (gray arrow). Set fascia aside to be reinstalled later.

5. To remove the belly pan from the underside of the car, use a 10MM socket and remove the five bolts shown above. Set bolts and belly pan aside to be reinstalled later.

BX3524

2011-12 Suzuki Kizashi Sport GTS Installation Instructions

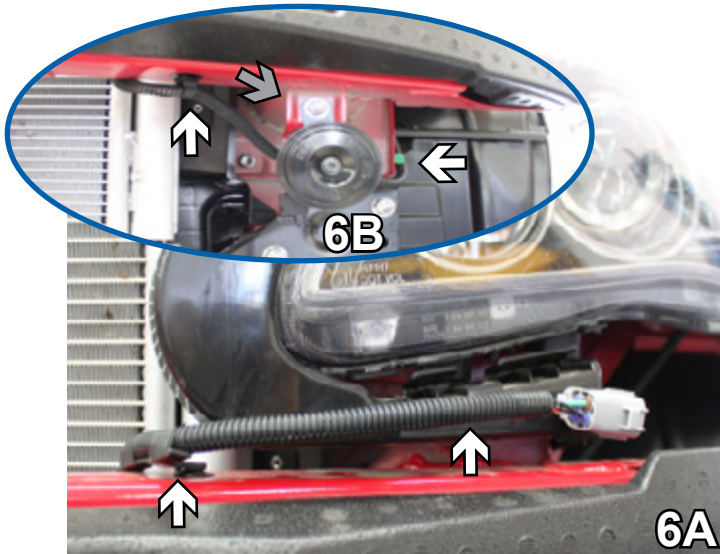

6. Disconnect the electrical cord from the front bumper, located in front of each headlight (6A), and below the front bumper (6B, white arrows). Use a 4MM socket and remove the bolt from the horn bracket (6B, gray arrow). Do this on both sides of the vehicle.

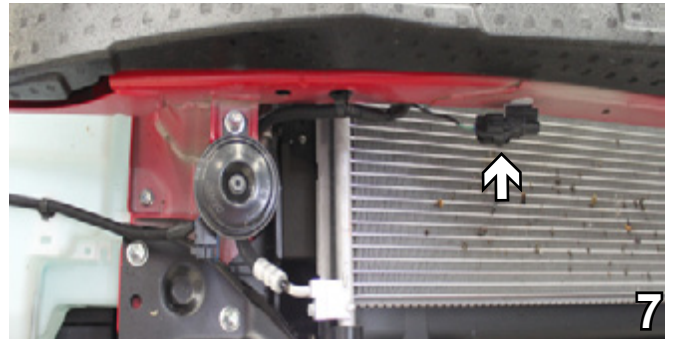

7. On the passenger's side only, disconnect the temperature sensor.
8. Use a 12MM socket and remove four bolts from each side of the bumper. Disconnect the bumper and set bolts and black styrofoam aside to be reinstalled later. Place the bumper **upside down** on a level workspace to fit with the baseplate.

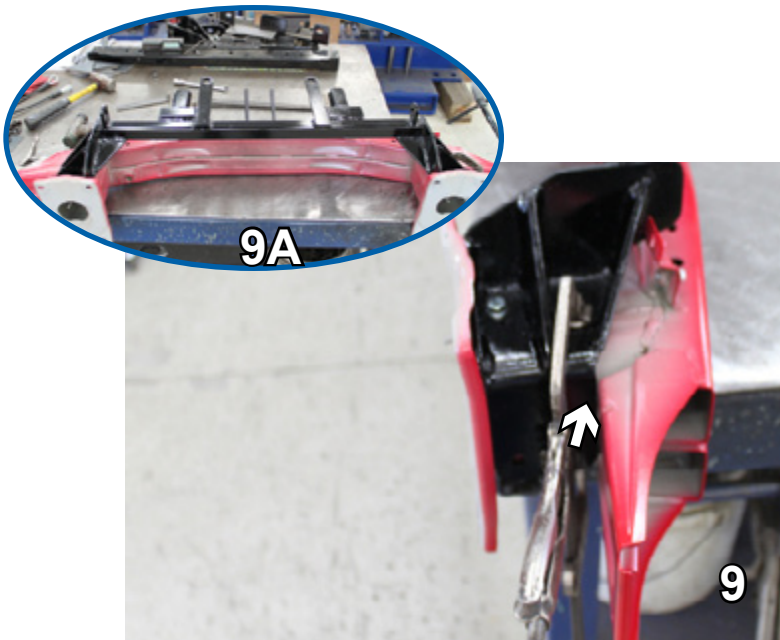

9. Placing the baseplate onto the bottom of the bumper and flush against its crossbar (9A), use a clamp to secure each side of the baseplate to the bumper's legs.

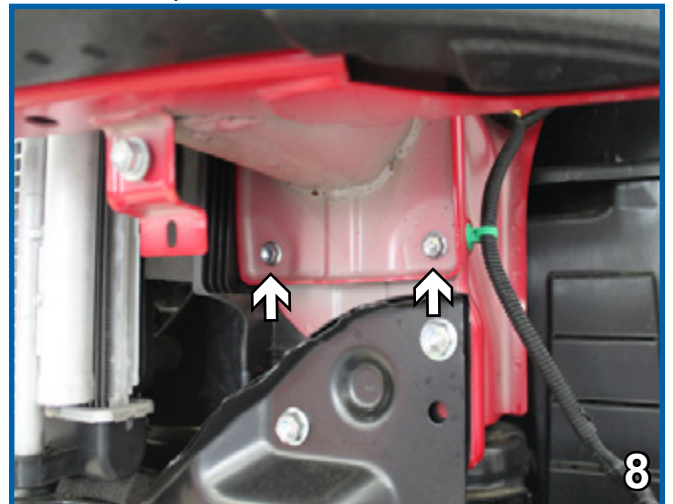

BX3524

2011-12 Suzuki Kizashi Sport GTS Installation Instructions

When using power drills be aware of the dangers of torque and drill bit length.

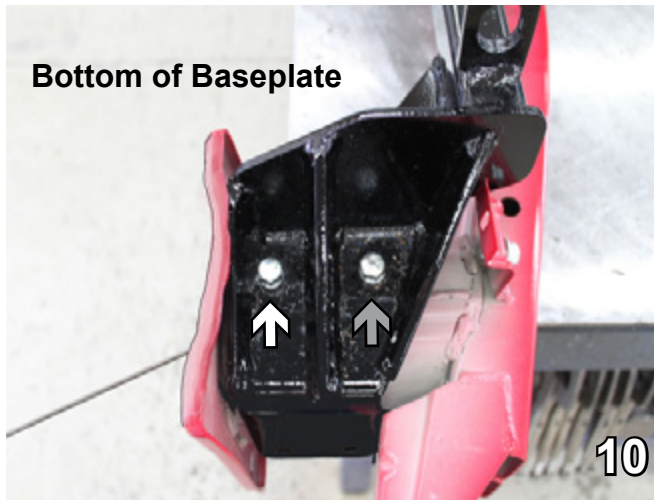

BE SURE TO USE LOCTITE® RED ON ALL BOLTS BEFORE TIGHTENING. TIGHTEN ALL BOLTS ACCORDING TO THE TORQUE CHART ON THE FRONT PAGE OF THESE INSTRUCTIONS OR ON PAGE 3 OF THE BASEPLATE TOWING GENERAL INSTRUCTIONS.

10. Using a 13/32" drill bit and the baseplate as a template, drill through the bottom back hole into the bumper (white arrow). Insert a 3/8-16 x 1 1/2" hex bolt with a 3/8" lock washer and a 1/4 x 1 x 1" nut plate. Do this on both sides first. Tighten with Loctite Red. Then repeat procedure on bottom front hole on both sides (gray arrow).

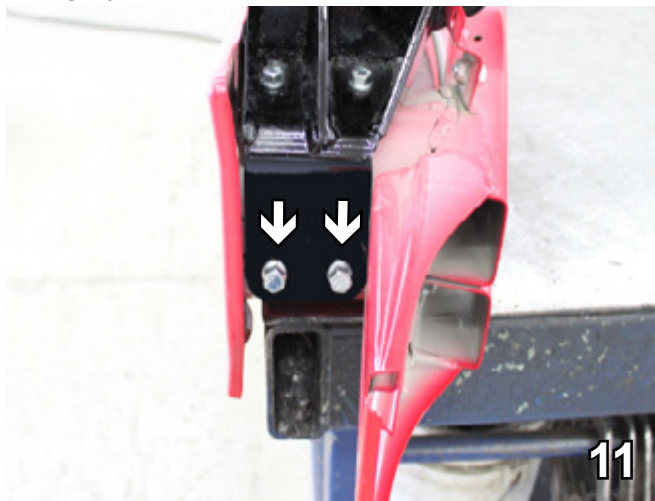

11. Again, using the baseplate as a template, drill the two side holes through the bumper on both sides using a 13/32" drill bit. Insert a 3/8-16 x 1 1/2" hex bolt with a 3/8" lock washer and a 1/4 x 1 x 1" nut plate. Tighten with Loctite Red. Do this on both sides of the vehicle.



12. Reinstall the bumper to its original position by using eight 8MM -1.25 x 30MM hex bolts with 8MM lock washers and 8MM flat washers. Tighten with Loctite Red. Reinstall the black styrofoam section of the bumper. Reinstall all electrical connections to the bumper.

BX3524

2011-12 Suzuki Kizashi Sport GTS Installation Instructions

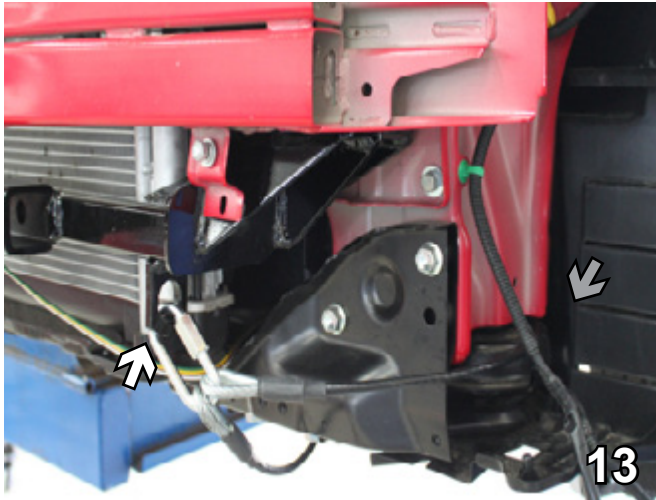

13. Attach the permanent baseplate safety cables to the provided convenience link on the baseplate (see white arrow). The photo above shows the recommended installation of the permanent baseplate safety cables to frame of the vehicle (see grey arrow). If the vehicle has additional options, not shown above, which interfere with mounting the permanent baseplate safety cables, secure the cable to a solid piece of the vehicle's frame as described in the instructions included with the permanent baseplate safety cables.

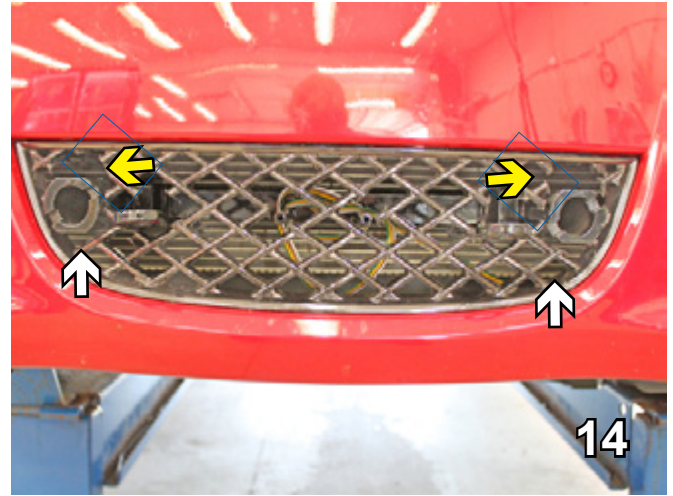

14. To allow for the attachment tabs, place the fascia into position and use a utility knife to trim the holes for the tabs (white arrows). Excess trimming is required to allow the fascia to fit over the hood latch for reinstallation (yellow arrows).

Be sure that **ALL** electrical connections are plugged in properly and functioning **BEFORE** installing the fascia.



15. **Optional:** To install a breakaway switch, use a self tapping screw and attach the bracket to the bottom of the front bumper, in front of the baseplate and in between the electrical bracket and convenience link on the baseplate. Attach the breakaway to the bracket with a 1/4-20 x 3/4" hex bolt and a 1/4-20 hex nylon nut.

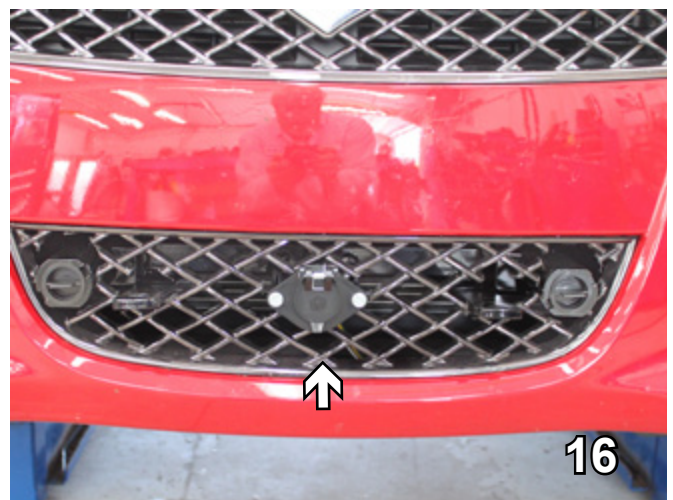

16. Reinstall the fascia, belly pan and all electrical connections using the existing bolts and push pins. Optional: Attach the electrical bracket to the center of the fascia (white arrow).

BX3524

2011-12 Suzuki Kizashi Sport GTS Installation Instructions

Install the tow bar and safety cables according to the instructions provided in their packages. When demonstrating to customer, be sure to include all original content and packages. Do **NOT** substitute other devices if the tow bar pins and clips are misplaced.

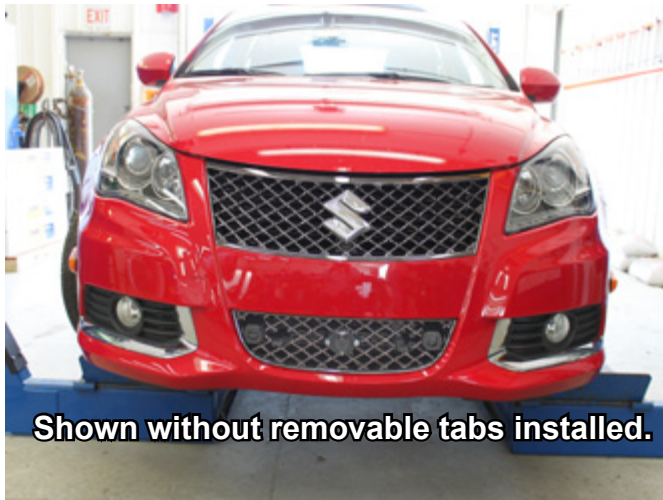

If the baseplate is in an accident, it must be replaced. DO NOT use it again! An accident can cause unseen damage and using it again could result in more damage or serious injury. DO NOT use the baseplate if it is damaged or missing parts.

DEALER or INSTALLER:
Be certain the user receives the instruction sheets for their products.

Customer Service Commitment

Blue Ox is committed to providing you with exceptional customer care throughout your lifetime with our products. Our team is here to assist you with any questions you may have regarding the performance of your product. Simply call (402) 385-3051 and you can speak with our customer care team.

Additionally, please visit our website to see which rallies our Destination America team will be attending. For a nominal fee, our service technician will service your towing system to ensure it's in proper working condition. Also, as a commitment to our customers, should you visit our factory you can stay at our full service Blue Ox campground at no charge along with enjoying a factory tour.

Again, thank you for being our customer and for the confidence you have shown in the performance of our products. It is because of customers like you we enjoy the success we have today.



© 2011 Blue Ox
One Mill Road, Industrial Park
Pender, Nebraska 68047
Phone: (402) 385-3051 • Fax: (402) 385-3360
www.blueox.com