



BX3733 Installation Instructions 1998 Toyota Sienna

Utilization of Blue Ox baseplates with any tow bar not approved by Automatic Equipment Mfg. Co. invalidates the limited warranty.

1. The bumper molding, and turn signal assemblies need to be removed to install the baseplate. The baseplate mounts to bottom of the metal bumper, the front edges of the tie down brackets and to the cross frame, eight holes need to be drilled. The lower grill opening on the outside edge and the bottom edge of the bumper molding need to be notched with this baseplate.
2. **Turn Signal Assemblies:** Remove each screw from the top of the turn signal assemblies. The turn signals can be pulled out from the vehicle.
3. **Center Grill:** The center plastic piece with the Toyota symbol needs to be removed also. There are four push pins that are on the top and four molded snaps on the bottom. Use a narrow screw driver to push in the center of the snaps and pull out the grill.
4. **Bumper Molding:** Removing the three push pins from the top of the molding. Remove the two push pins in the opening of the molding and the remaining push pins from the bottom. Loosen the front of the fender well plastic. Reach in and remove the 10MM bolt that holds each quarter panel and the molding. The molding can now be removed.
5. **Mounting the Baseplate:** Hold the upper braces to the bottom of the metal bumper. With a helper hold the outside brace to the lip of the tie down brackets. Clamp the baseplate to the frame and drill 13/32" holes using the baseplate as a template. Insert a bolt, washer and nut after each hole is drilled so the baseplate does not move while drilling. **Use Loctite Blue with each bolt to insure they do not loosen while vehicle is being towed, be sure to read instructions on bottle.** Now drill holes for the upper braces. Use the 3/8" bolts and washers along with the 3/8" wire nuts as shown in the diagram on page 2. Once all the bolts have been started, tighten bolts completely. Use the braces that extend back to the cross frame as templates to drill the 3/8" holes in the frame. There are small holes in cross frame which may need to be widened so the wire nuts can be inserted. Use the 3/8" hardware to bolt the braces to the cross frame. Tighten bolts according to the torque guidelines in the General Instruction Sheet. The drivers side rear brace may have a bolt that is in the way for installation, remove the bolt and then install rear braces.
6. **Replace Bumper Molding:** Trim the lower grill opening on the outside lower edges where the attachment tabs protrude out. The outside vertical plastic pieces need to be removed completely and the very bottom of the molding needs to be notched where the braces extend back to the cross frame. Hold molding up to its original position and mark where it needs to be trimmed.
7. The dimensional variations between otherwise identical cars can be considerable. While the location and size of the holes in the baseplate were designed to allow for easy installation, it may be necessary to file a hole slightly.
8. Install the tow bar and safety cables according to the instructions included in their packages.

Automatic

- 9. Do not substitute other devices if the tow bar pin and clip are lost.
- 10. DEALER OR INSTALLER: BE CERTAIN THE USER RECEIVES THE INSTRUCTION SHEET.

Tools Required

9/16" Wrench
Hack Saw

10MM Wrench
13/32" Drill Bit

Utility Knife
Drill

Loctite
C-Clamp (2)

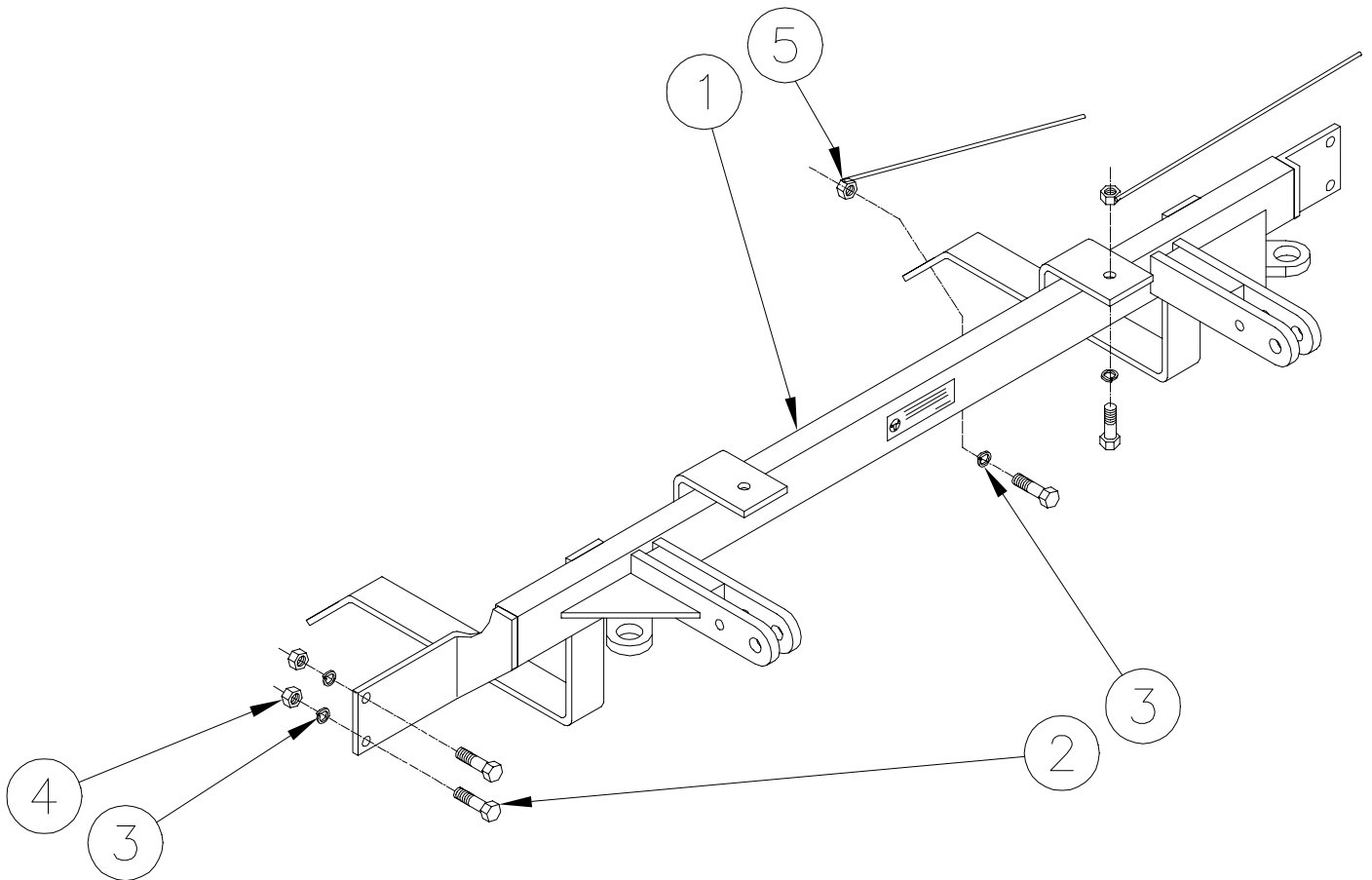

Parts List

Ref. No.	Qty.	Part No.	Description
1	1	61-5157	Baseplate, BX3733
2	8	201-0368	3/8 x 1 1/4 Hex Bolt, Grade 5
3	8	203-0010	3/8 Lock Washer
4	4	202-0003	3/8 Hex Nut
5	4	61-5217	3/8 Nut with Wire