

INSTALLATION INSTRUCTIONS

⚠ WARNING: DO NOT EXCEED PRODUCT RATING OR TOW VEHICLE LAMP LOAD RATING, WHICHEVER IS LOWER

APPLICATIONS

Make	Model
Infiniti	G25 sedan
Infiniti	G35 sedan
Infiniti	G37 sedan
Nissan	Rogue

CUSTOM WIRING HARNESS

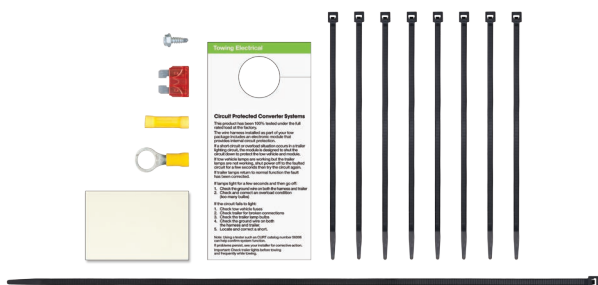
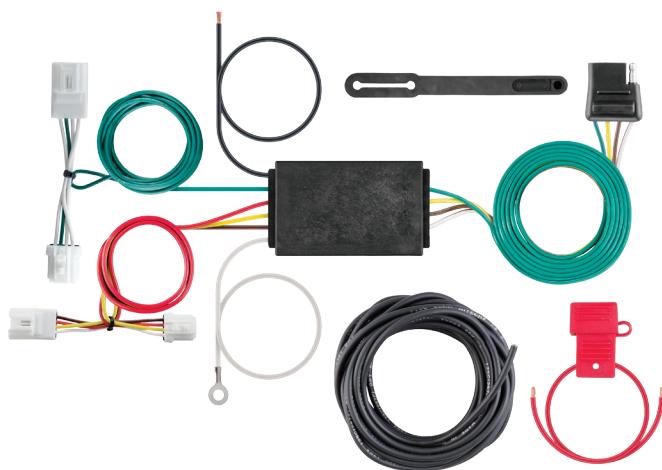

⚠ WARNING ⚠ ⚡

The battery connection must be fuse-protected, 10-amp max. Exceeding the product rating can cause loss of warranty, overheating and potential fire. Do not exceed product rating or tow vehicle lamp load rating, whichever is lower.

Signal Circuits - 3.0 amps per side
Tail / Running Circuits - 6.0 amps total

Check vehicle owner's manual or contact the vehicle manufacturer for more information.

WIRING LOCATION GUIDE

PASSENGER CARS (P)

Representative vehicle shown below

P3 - Behind driver side taillight housing, inside of trunk

P4 - Behind passenger side taillight housing, inside of trunk



SUVS, MINI & FULL-SIZED VANS (S)

Representative vehicle shown below

S3 - Behind driver side rear access panel

S4 - Behind passenger side rear access panel



NOTICE ⓘ ⓘ

All steps must be followed to ensure the wiring harness will function properly. Once installed, test for proper function by using a test light or connecting a properly wired trailer.

TOOLS NEEDED

Ratchet
10mm socket
Phillips screwdriver

Flat blade screwdriver
Panel trim removal tool

INSTALLATION / SAFETY INSTRUCTIONS

Step 1

Locate vehicle battery on the driver side under the hood and disconnect the negative battery terminal.

Step 2

Nissan Rogue

Open the vehicle trunk. Remove the rear scuff panel, storage covers and floor coverings (A).

Infiniti G25 / G35 / G37

Open the vehicle tailgate. Remove the rear scuff panel.

Step 3

Nissan Rogue

Remove the fasteners securing the rear trim panels on the driver and passenger sides (B). Remove the trim panels to locate the vehicle taillight wiring harness connectors. The connectors will be similar to those on the custom wiring harness. Separate the connectors from the taillight housing taking care not to damage the locking tabs (C).

Infiniti G25 / G35 / G37

Pull back on the felt liner to locate the vehicle taillight wiring harness connectors. The connectors will be similar to those on the custom wiring harness. Separate the connectors from the taillight housing taking care not to damage the locking tabs (D,E).

Step 4

On the driver side, insert the custom wiring harness end with yellow wire between the separated connectors. Make sure the connectors are fully inserted with locking tabs in place.

Step 5

Route the custom wiring harness end with the green wire to the passenger side behind the removed scuff panels. Repeat step 4 on the passenger side using the harness end with the green wire.

Step 6

Locate a suitable grounding point near the connector such as an existing screw with nut in the vehicle frame or drill a 3/32" pilot hole for the provided screw. The area should be free of rust, dirt and paint. Secure the white ground wire using the ring terminal and provided screw.

 **WARNING:** Check for miscellaneous items that may be hidden behind or under any surface before drilling to avoid damage and / or personal injury.

Step 7

Locate a flat spot inside the vehicle, near the taillight. Adhere the black converter box using the provided double-sided tape.

Step 8

Route the black power wire from the vehicle battery as shown on the included CME-PCL-INS sheet.

Step 9

Reinstall all items removed during install and reconnect negative battery terminal. Install the provided 4-flat dust cover to help prevent corrosion.

