

IN-BED SPARE TIRE CARRIER RHTC-35L

TOOLS REQUIRED:
DRILLS: 5/16" & 3/8"
**WRENCHES: RATCHET, TORQUE WRENCH,
 9/16" SOCKET**

**WARNING: CONSULT VEHICLE OWNER BEFORE DRILLING. DO NOT ALTER THIS
 PRODUCT IN ANY MANNER OR WARRANTY WILL BE VOIDED**

NOTE: INSTALL ALL PARTS LOOSELY
 UNTIL ALL ATTACHMENTS ARE MADE.

1. ASSEMBLE THE MAIN MOUNTING BAR TO THE ANGLE BRACKET USING (2) 3/8" CARRIAGE BOLTS AND FLAT WASHERS. SECURE WITH LOCK WASHERS AND HEX NUTS PROVIDED. USE ANY TWO ATTACHMENT HOLES TO ACHIEVE DESIRED HEIGHT. NOTE FOR STABILITY ALWAYS SPACE BOLTS AS FAR APART AS POSSIBLE.
2. PLACE THE CARRIER IN THE DESIRED AREA OF THE TRUCK BED. BEFORE DRILLING, INSPECT THE AREAS TO BE DRILLED FOR POSSIBLE INTERFERENCE. USING THE CARRIER AS A TEMPLATE, DRILL A 5/16" HOLE IN THE TRUCK BED AND A 3/8" HOLE IN THE SIDE RAIL OF THE TRUCK BOX.
3. SECURE THE TOP OF THE CARRIER TO THE TRUCK BOX USING THE REMAINING 3/8" CARRIAGE BOLT, LOCK WASHER, AND HEX NUT. ATTACH THE ANGLE BRACKET TO THE TRUCK BED USING THE 3/8" SELF TAPPING BOLT. TIGHTEN ALL FASTENERS TO 18 FT-LB.
4. INSERT THE 5-1/2" CARRIAGE BOLT THROUGH THE WING BRACKET AND SECURE WITH THE PUSH NUT PROVIDED. SLIDE THE TIRE HOLD DOWN ONTO THE CARRIAGE BOLT AS SHOWN. INSERT THE ENTIRE ASSEMBLY THROUGH THE CENTER HOLE OF THE WHEEL AND SECURE IT TO THE MAIN MOUNTING BAR.

FOR SECURITY, A HOLE IS PROVIDED IN THE WING BRACKET FOR USE WITH A CABLE OR CHAIN AND A PADLOCK.

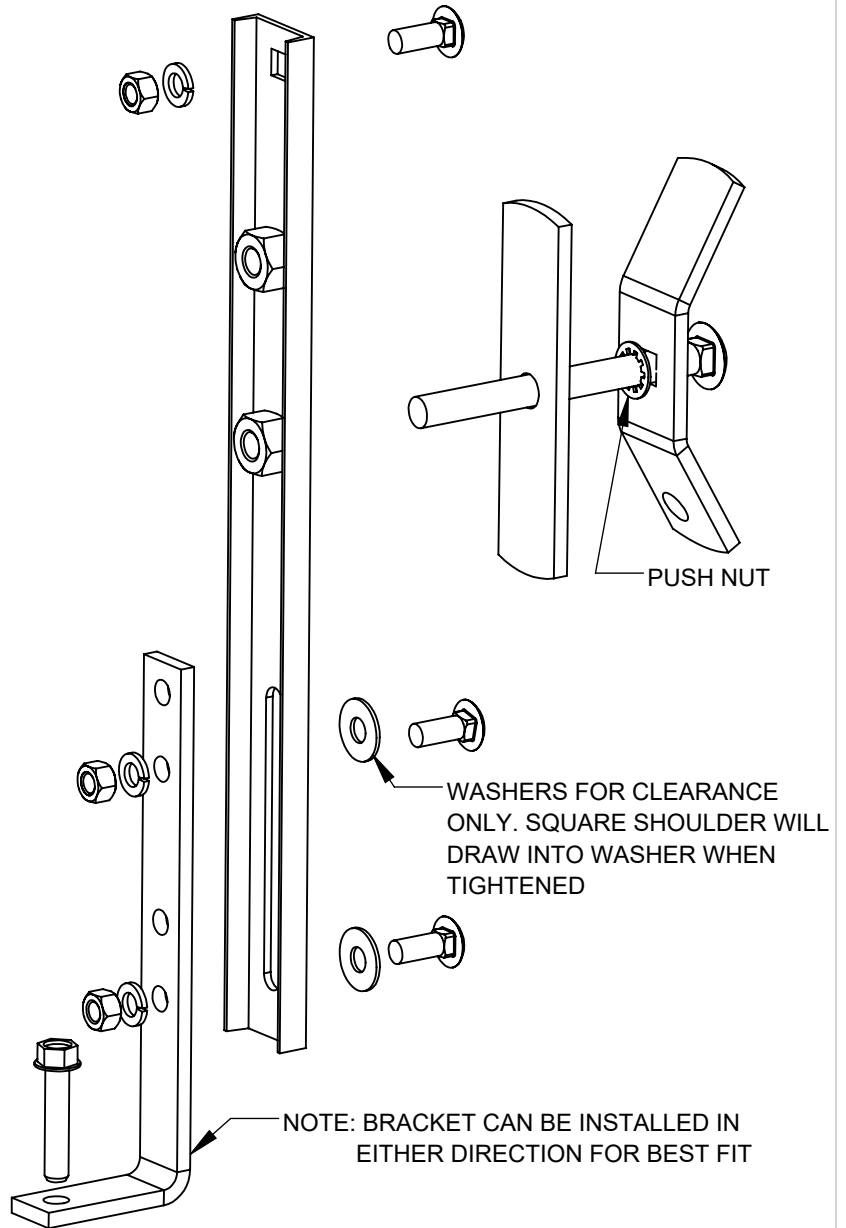

THANK YOU FOR PURCHASING A RIGID HITCH MADE PRODUCT

HARDWARE INCLUDED:	(3) 3/8"-16 X 1-1/4" CARRIAGE BOLTS	(1) 1/2" PUSH NUT
	(2) 7/16" FLAT WASHERS	(1) 3/8" X 1-1/2" SELF TAPPING BOLT
	(3) 3/8" LOCK WASHERS	(1) 1/2"-13 X 5-1/2" CARRIAGE BOLT
	(3) 3/8"-16 HEX NUTS	

GIVE THIS INSTRUCTION SHEET TO VEHICLE OWNER



RIGID[®]
HITCH INCORPORATED
 3301 WEST BURNSVILLE PARKWAY
 BURNSVILLE, MN 55337